

GENERAL NOTES:
 RECHARGER 330XLHD BY CULTEC, INC. OF BROOKFIELD, CT.
 STORAGE PROVIDED = 11.32 CF/FT PER DESIGN UNIT.
 REFER TO CULTEC, INC.'S CURRENT RECOMMENDED INSTALLATION GUIDELINES.
 USE RECHARGER 330XL HD HEAVY DUTY FOR TRAFFIC AND/OR HIGH APPLICATIONS.

ALL RECHARGER 330XL HD HEAVY DUTY UNITS ARE MARKED WITH A COLOR STRIPE FORMED INTO THE PART ALONG THE LENGTH OF THE CHAMBER.
 ALL RECHARGER 330XL HD CHAMBERS MUST BE INSTALLED IN ACCORDANCE WITH ALL APPLICABLE LOCAL, STATE AND FEDERAL REGULATIONS.

DRY WELL DETAIL NOT TO SCALE

INSPECTION PORT DETAIL NOT TO SCALE

NOT TO SCALE

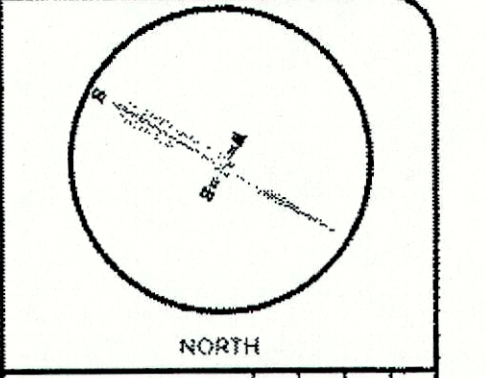
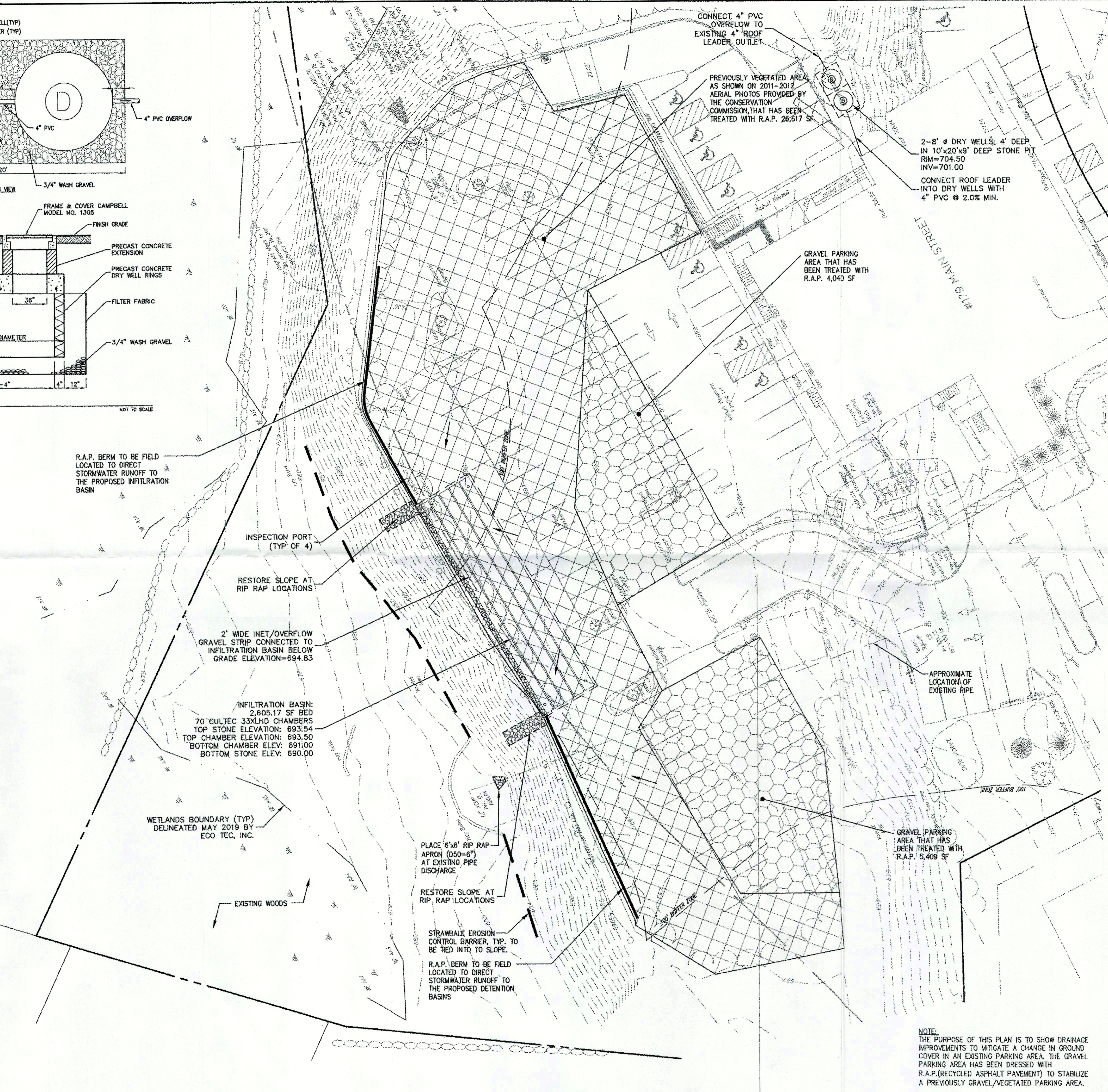

NO.	DATE	REVISION	BY

CALISTO J. BERTIN, P.E.
 PROFESSIONAL ENGINEER
 MA LIC. NO. 44298
 NH LIC. NO. 9398
 NJ LIC. NO. 28845
 N.Y. LIC. NO. 60022
 RI LIC. NO. 6994

DRAINAGE IMPROVEMENT PLAN FOR REAR PARKING LOT

PROJECT LOCATION:
 179 MAIN STREET
 STURBRIDGE, MA 01566

BERTIN ENGINEERING
 179 MAIN, LLC
 179 MAIN STREET
 STURBRIDGE, MA 01566

DESIGNED BY: FWB
 CHECKED BY: FWB

SCALE: 1"=20'
 DATE: 6-21-2019
 PROJECT NO.: 12-627
 DWG. NO.: D-1

NOTE:
 THE PURPOSE OF THIS PLAN IS TO SHOW DRAINAGE IMPROVEMENTS TO MITIGATE A CHANGE IN GROUND COVER IN AN EXISTING PARKING AREA. THE GRAVEL PARKING AREA HAS BEEN DRESSED WITH R.A.P. (RECYCLED ASPHALT PAVEMENT) TO STABILIZE A PREVIOUSLY GRAVEL/VEGETATED PARKING AREA.